



Brooklin Development General Partner Ltd. Brooklin Development LP.
Matthew Cory, RPP, MCIP, PLE, PMP
Employment Conversion Request

SPECIAL COUNCIL MEETING
May 17, 2023

MALONE GIVEN PARSONS LTD.

Proposed Revisions to Map 1 – Regional Structure

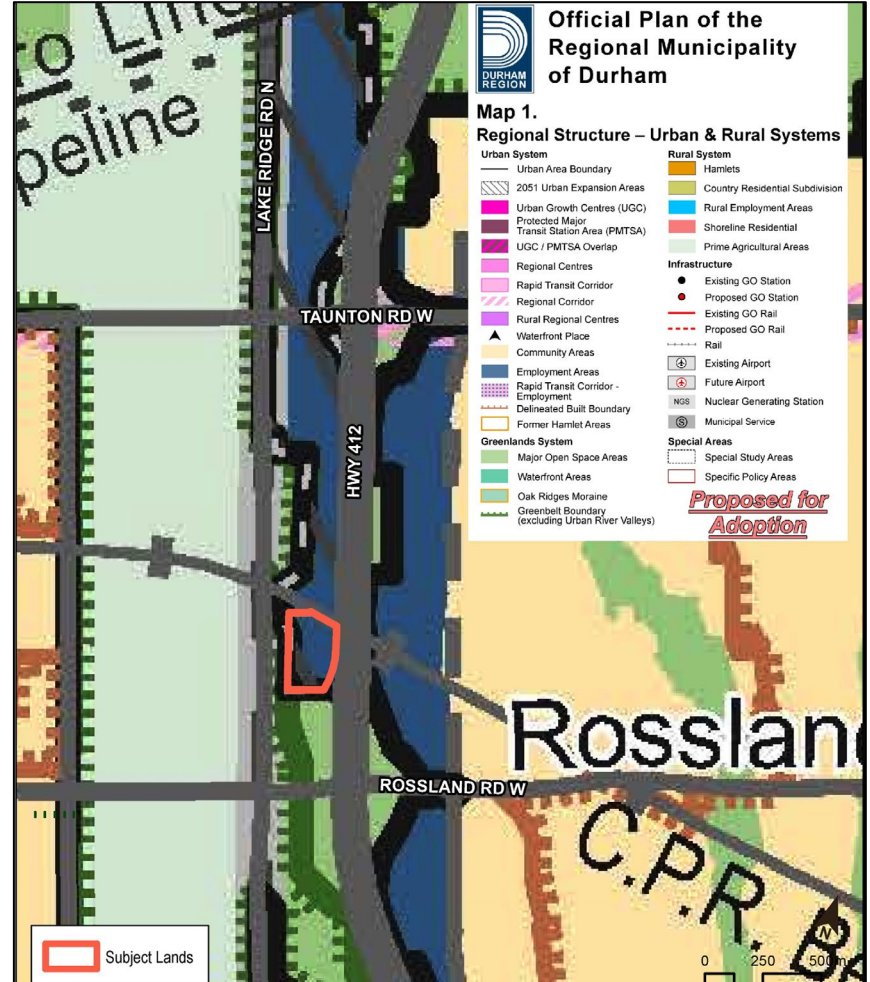
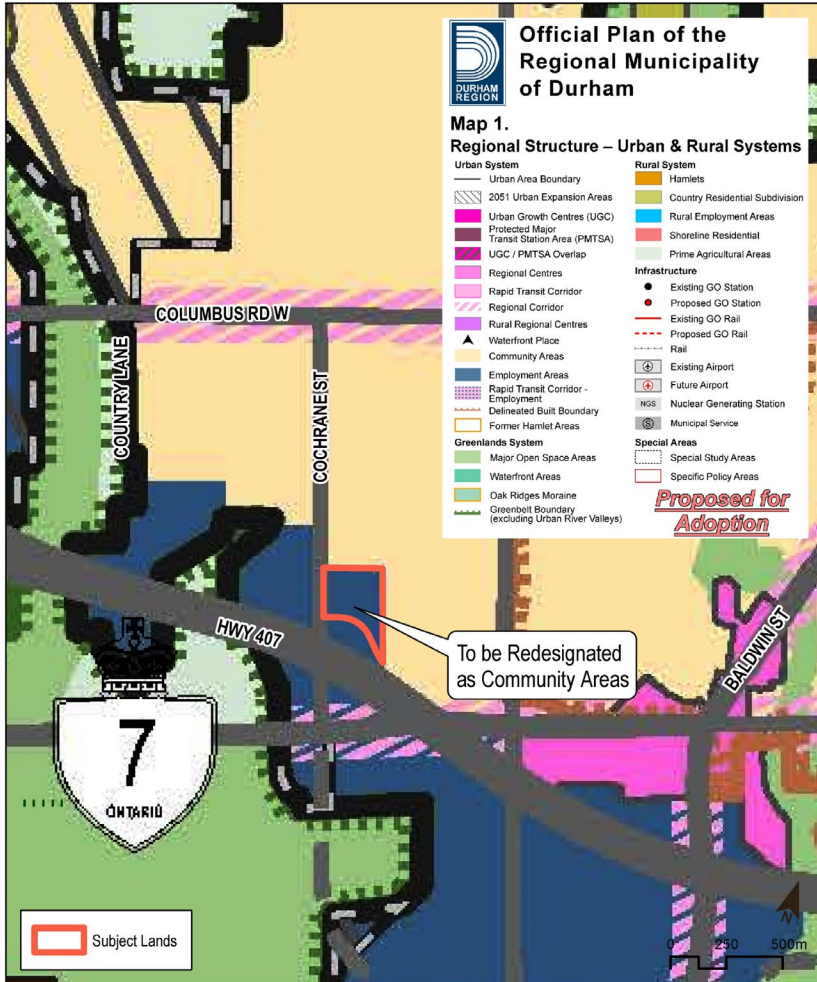

Draft Approved Plan of Subdivision (SW-2020-02)

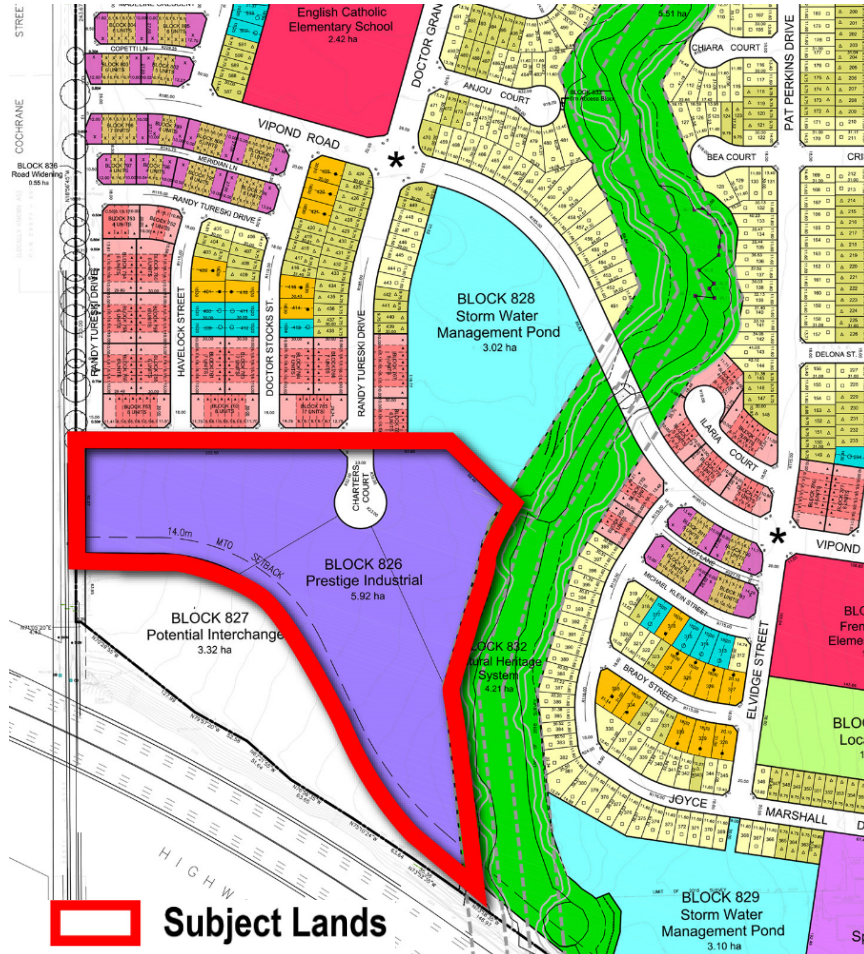

Subject Lands

DRAFT PLAN OF SUBDIVISION XXT-XXXXXX

Part Lots 27 and 28,
Concession 6
(Geographic Township of Whitby)
Now in the
Town of Whitby
Regional Municipality of Durham

KEY PLAN



SCHEDULE OF LAND USE

Lot/Block	Land Use	Units	Area(ha)
Lots 1 - 737	Single Detached min. 9.75m (32ft)	262	29.68
	Single Detached min. 11.6m (38ft)	354	
	Semi Detached min. 7.6m (25ft)	120	
	Semi Detached min. 9.15m (30ft)	122	
Block 738-739	Future Development	237	0.38
Block 740-779	Street Townhouses min. 6.1m (20ft)	122	5.47
Block 780-809	Laneway Townhouses min. 6.1m (20ft)	177	3.83
Block 810-817	Future Development	108	0.84
Block 818-820	Elementary School	1	7.17
Block 821	District Park	4	4.00
Block 822-823	Local Parks	2	2.58
Block 824	Local Commercial	1	0.96
Block 825	Spacer Purpose Commercial	3	3.12
Block 826	Prestige Industrial	1	5.92
Block 827	Potential Future Interchange	1	3.32
Block 828-829	Storm Water Management Ponds	1	6.12
Block 830-832	Access Road	1	15.53
Block 833	Access Road	1	0.91
Block 834-837	Road Widening	1	1.84
Public Roads	Street 'X' 30.0m ROW	804m	23.38
	Streets 'B' & 'C' 25.0m ROW	1,027m	
	Streets 'B' & 'C' 20.0m ROW	927m	
	Streets 'D' 20.0m ROW	2,769m	
	Streets 'D' 30.0m ROW	4,000m	
Laneways 'W' & 'G'	4.5m ROW	989m	12.2m
	7.5m ROW	122m	
	8.5m ROW	845m	
Total		1,372	111.59

Unit Type	1 Car Garage	2 Car Garage	Total
Single Detached min. 9.75m (32ft)	262	262	524
Single Detached min. 11.6m (38ft)	354	354	708
Semi Detached min. 7.6m (25ft)	120	120	240
Semi Detached min. 9.15m (30ft)	122	122	244
Street Townhouses min. 6.1m (20ft)	158	158	316
Laneway Townhouses min. 6.1m (20ft)	117	79	196
Laneway Townhouses min. 8.5m (28ft)	60	60	120
Total Units	657	615	1272